

High-Line/Comp-Line Adaptor Mounting Guide

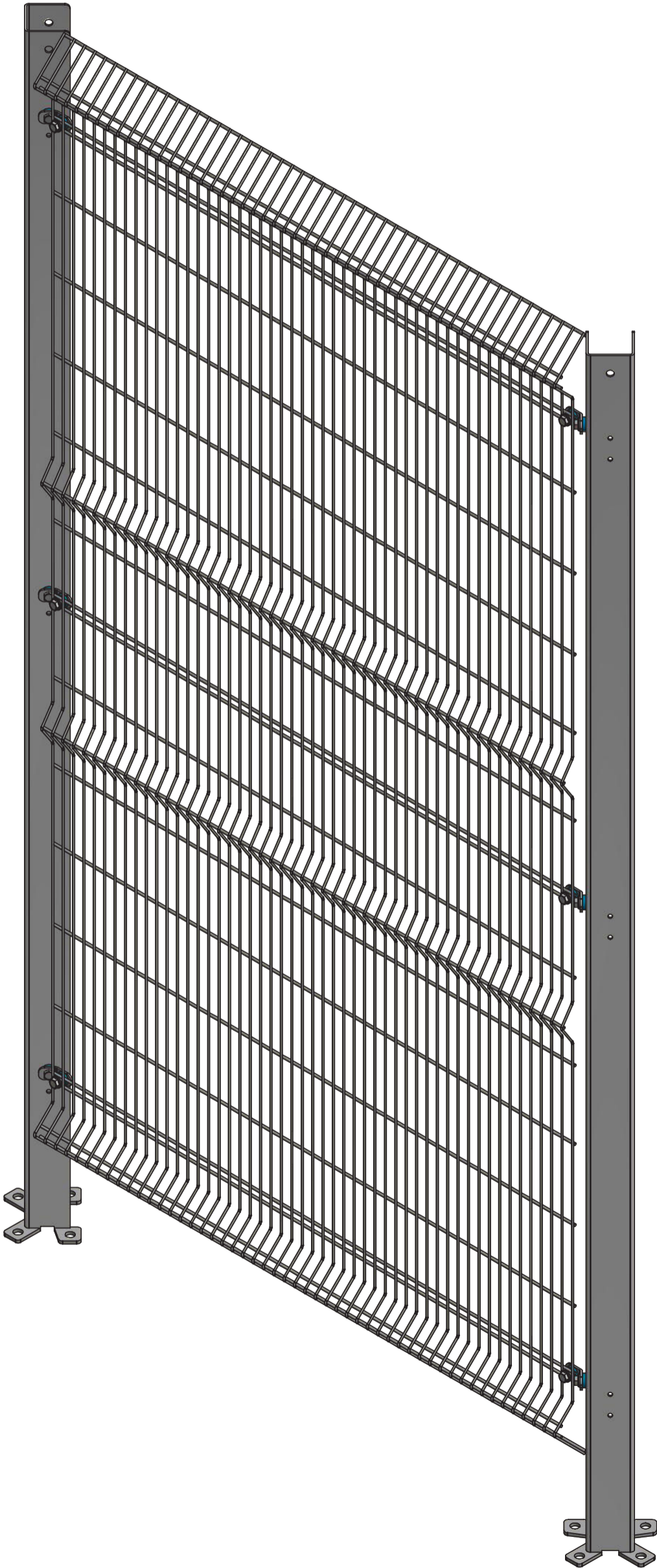

High-Line/Comp-Line Adaptor Mounting Guide

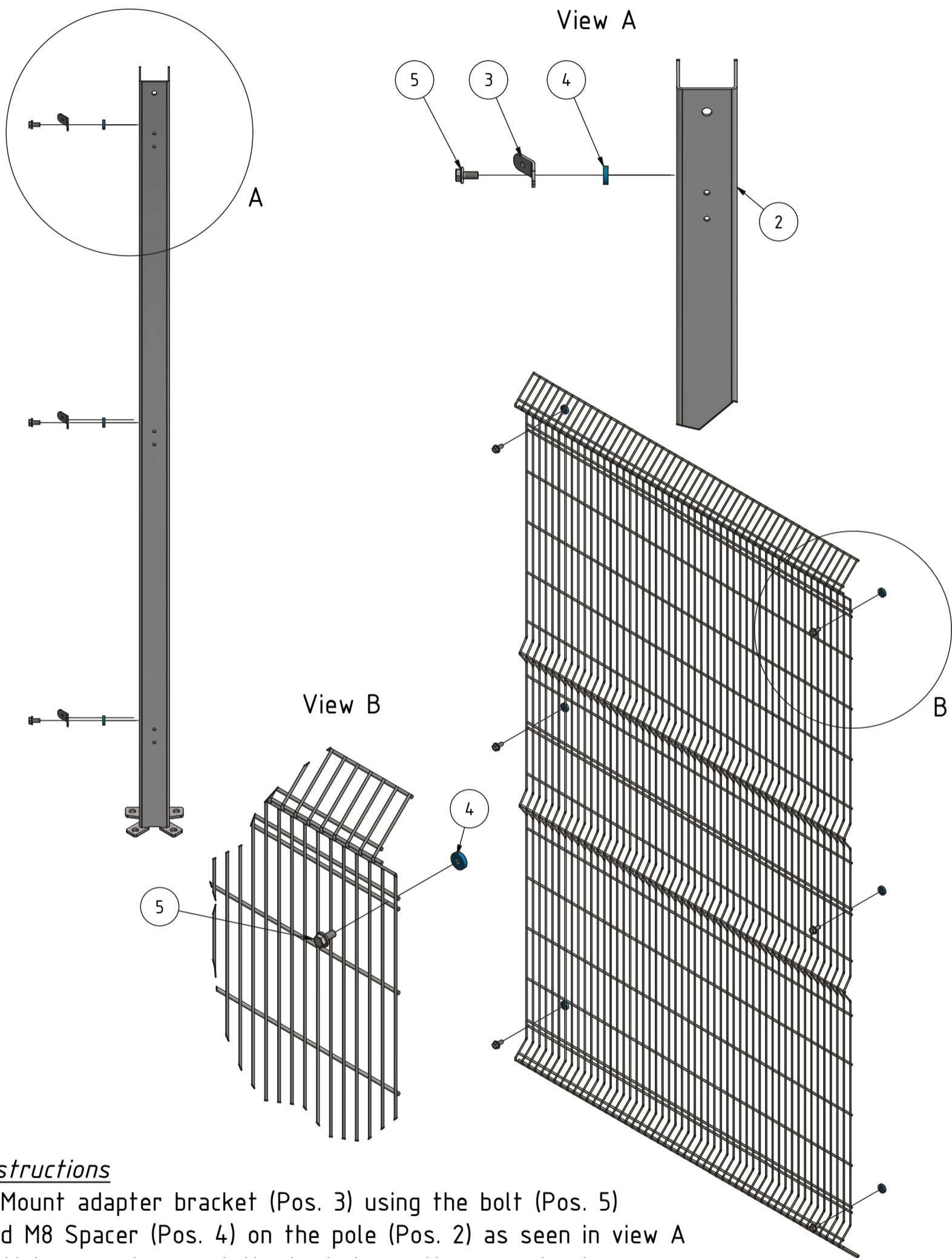

Instructions

1. Mount adapter bracket (Pos. 3) using the bolt (Pos. 5) and M8 Spacer (Pos. 4) on the pole (Pos. 2) as seen in view A
2. Make sure to mount the brackets on the second pole on the opposite side as the first.
3. Mount the bolt (Pos. 5) and Spacer (Pos, 4) on the net. the bolt should be mounted between the two horizontal threads. As shown in View B

PARTS LIST		
ITEM	QTY	PART NUMBER
1	1	A003-001
2	2	A001-025
3	6	M005-247
4	12	M001-291
5	12	M001-289

High-Line/Comp-Line Adaptor Mounting Guide

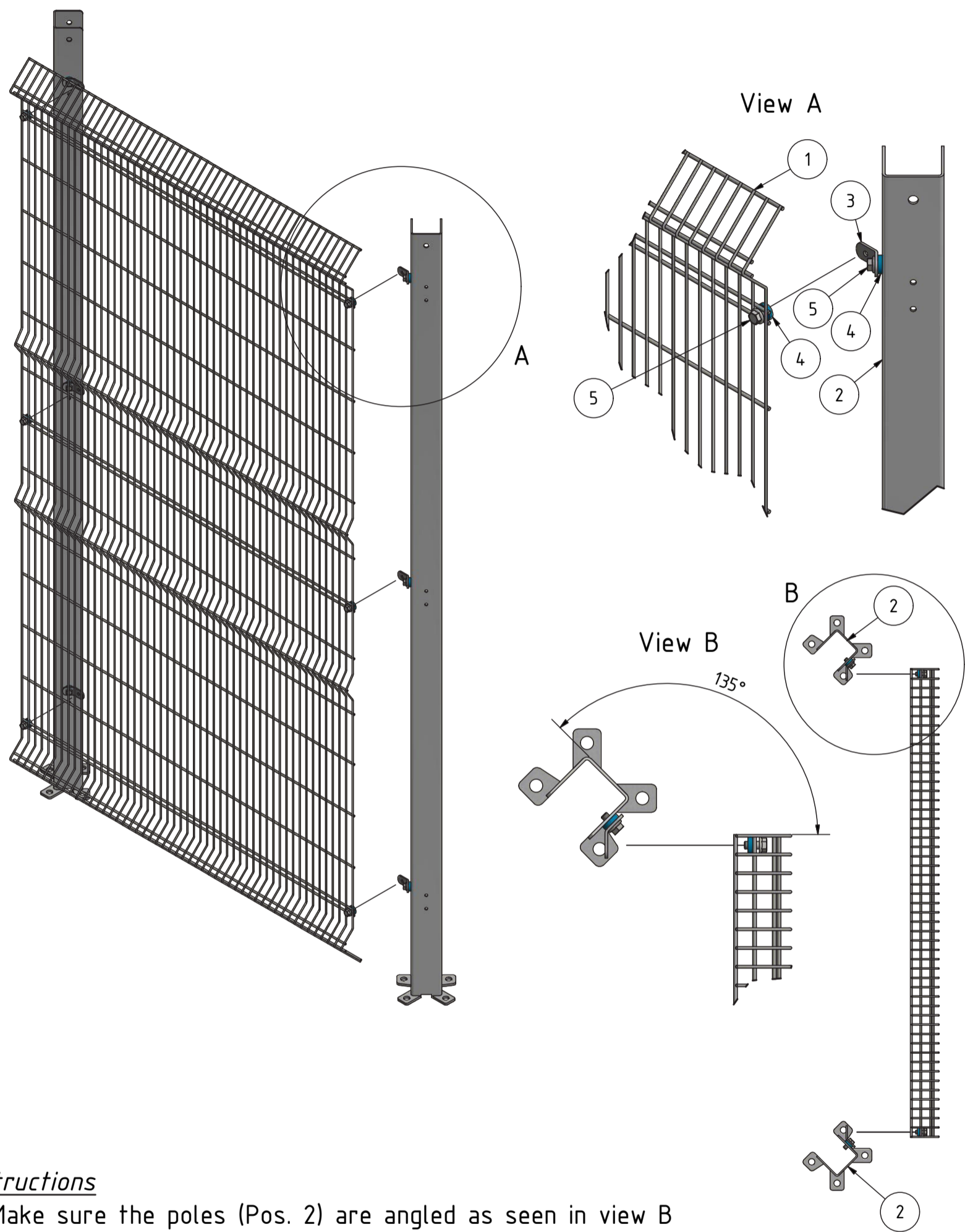

Instructions

4. Make sure the poles (Pos. 2) are angled as seen in view B they should be roughly angled at 135° from the side of the net.
5. Mount net as seen in View A, the spacer (Pos. 4) will keep the bolt in place and you can easily tighten the bolt after mounting them.

PARTS LIST		
ITEM	QTY	PART NUMBER
1	1	A003-001
2	2	A001-025
3	6	M005-247
4	12	M001-291
5	12	M001-289